



Available finish:- Anthracite Finish

Read these instructions before commencing installation. Please give these instructions to the owner/occupier after installation to retain for future reference/maintenance.

IP44 240VAC~50Hz 2.9W

These fittings are Class I and must be Earthed

## Important Information

It is recommended that these luminaires are installed and fitted by a qualified electrician ensuring the installation complies with current IEE wiring regulations & local building control. These products are designed for connection to a 240V~50Hz supply.

Any faulty, broken or damaged luminaires should be replaced immediately.

KSR will not accept responsibility for any claims arising from a poor installation.

Please Note: The limited warranty shall be deemed null and void in the following circumstances: Failure by the installer, end user or any third party to exercise caution to protect any covered product or part from outside damage, adverse temperature (normal operating ambient temperature -20 ~ +40°C), humidity conditions, fluctuations in the electrical system or physical abuse as well as failure related to workmanship in the installation of the products or parts.

## General Maintenance

These products are suitable for external use, general maintenance and cleaning should be performed at least quarterly.

Clean product outer using a damp cloth, do not use abrasive cleaners as this may damage the finish. After any maintenance, remember to check all seals are intact. Always switch off mains supply before servicing.

Do not use Megger or similar high voltage instruments. Due to the fact this luminaire contains electronic components that maybe damaged by high test voltages, they must be disconnected from the circuit before testing.

To prevent damage to the driver, do not mix with conventional magnetic ballasts on the same electrical circuit.

At the end of life the luminaire is classed as WEEE under directive 2014/30/EU and should be disposed of in accordance with local legislation.

## Installation Procedure

Familiarize yourself with the luminaire, and ensure the mains power is turned off before installation.

Remove the front cover and glass diffuser from the fitting.

Offer the luminaire up and mark the two fixing points, taking care not to damage other services drill the fixing holes.

Feed the mains supply cable through the grommet and secure the luminaire to the wall.

Terminate the wiring into the terminal block, ensuring correct polarity. Ensure the earth cable is secured to the body of the luminaire using the dedicated connection point.

Replace the diffuser and front rim, do not overtighten these screws or distort the gasket.

Turn on the power and test the luminaire.

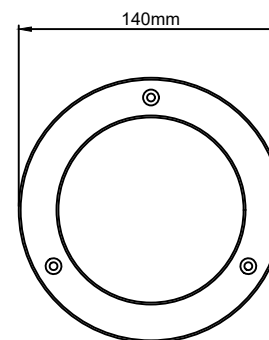
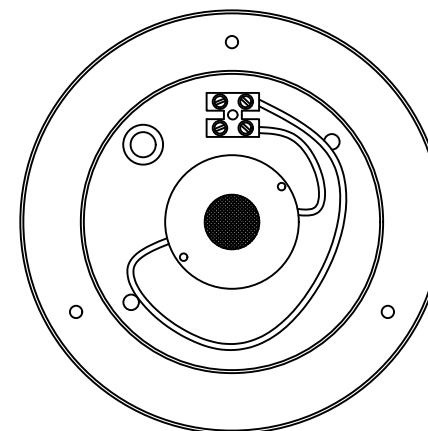

KSR1238

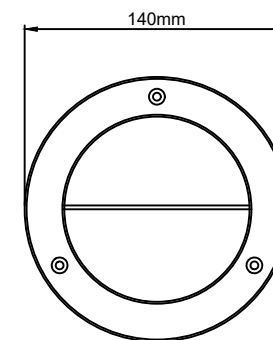

KSR1240

## Output Details

KSR1238/40- 3W Integral LED Module

KSR1238 - 2.9w 195lm

KSR1240 (Eyelid Version) - 2.9w 64lm  
6000k Cool White

The light source of this luminaire is not replaceable; when the light source reaches its end of life the whole luminaire shall be replaced

This product contains a light source of energy efficiency class G

KSR Lighting Aftersales: 023 92 674343

E-mail: aftersales@ksrlighting.com

