

Read these instructions before commencing installation & retain them for future reference.

IP65    $0.3m$  **240V 1.5W**

These fittings are Class II and do not require an Earth

Important Information

It is recommended that luminaires are installed and fitted by a qualified electrician ensuring the installation complies with current IEE wiring regulations & local building control. These products are designed for connection to a 240V 50Hz supply. Any broken or damaged parts should be replaced as soon as possible. KSR will not accept responsibility for any claims arising from a poor installation.

General Maintenance

General maintenance and cleaning should be performed at least quarterly. Clean product outer using a damp cloth, do not use abrasive cleaners as this may damage the finish. After any maintenance, remember to check all seals are intact.

Installation Procedure

Familiarize yourself with the luminaire, and ensure the mains power is turned off before installation.
Unclip the front cover from the fitting to expose the clear diffuser.
Remove the four diffuser retaining screws, remove the diffuser.
Offer the luminaire up and mark the four fixing points, taking care not to damage other services drill the fixing holes.
Feed the mains supply cable through the grommet and secure the luminaire to the wall.
Terminate the wiring into the terminal block, ensuring correct polarity.
Replace the clear diffuser and tighten the four screws, do not overtighten these screws or distort the gasket.
Clip the front cover back onto the luminaire, switch on the power and test the fitting.

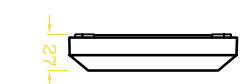
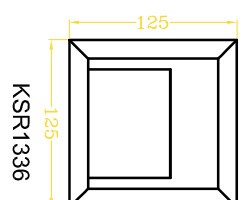
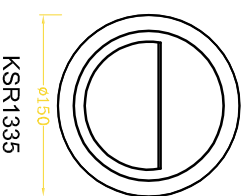
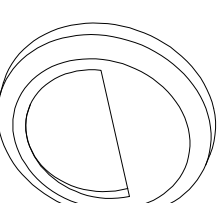
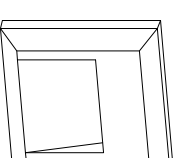
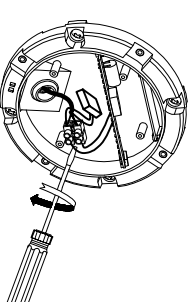
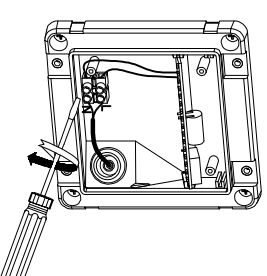
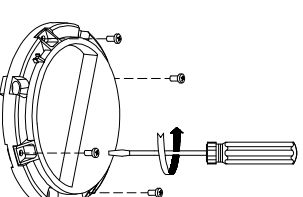
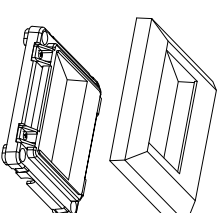

Output Details

KSR1335 - 1.5W Integral LED Module, Round
KSR1336 - 1.5W Integral LED Module, Square
Non Replaceable
3000K Warm White
4000K Cool White

KSR Lighting After-sales: 023 92 674343
E-mail: info@ksr-lighting.co.uk