



Read these instructions before commencing installation. Please give these instructions to the owner/occupier after installation to retain for future reference/maintenance.

IP67    12VDC 3W LED

## Important Information

It is recommended that these luminaires are installed and fitted by a qualified electrician ensuring the installation complies with current IEE wiring regulations & local building control. These products are designed for connection to a 12V Constant Voltage DC supply. Any faulty, broken or damaged luminaires should be replaced immediately. KSR will not accept responsibility for any claims arising from a poor installation. Please Note: The limited warranty shall be deemed null and void in the following circumstances: Failure by the installer, end user or any third party to exercise caution to protect any covered product or part from outside damage, humidity conditions, fluctuations in the electrical system or physical abuse as well as failure related to workmanship in the installation of the products or parts.

## General Maintenance

These products are suitable for external use, general maintenance and cleaning should be performed at least quarterly. Clean product outer using a damp cloth, do not use abrasive cleaners as this may damage the finish. After any maintenance, remember to check all seals are intact. Always switch off mains supply before servicing. Do not use Megger or similar high voltage instruments. Due to the fact this luminaire contains electronic components that may be damaged by high test voltages, they must be disconnected from the circuit before testing. To prevent damage to the driver, do not mix with conventional magnetic ballasts on the same electrical circuit. At the end of life the luminaire is classed as WEEE under directive 2014/30/EU and should be disposed of in accordance with local legislation.

## Installation Procedure

KSR recommends that you familiarise yourself with the installation. Once you are satisfied: Install sleeve into a concrete base or cut 102mm hole, making sure below the bottom of the sleeve is at least 300mm of suitable substrate to allow for drainage and that the top of the sleeve is raised so the luminaire will not be immersed in water (Fig. 1). Connect the luminaire to a 12v Constant voltage driver this must be wired in parallel. See Fig.2 Turn on mains supply and test luminaire is working correctly.

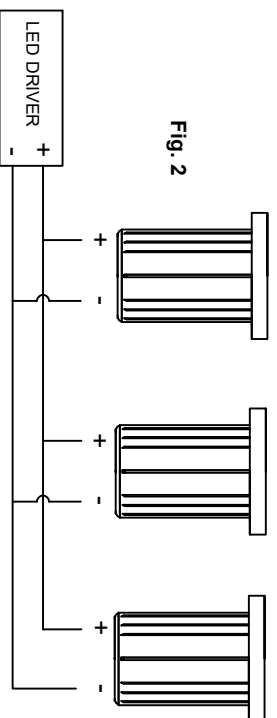

Fig. 2

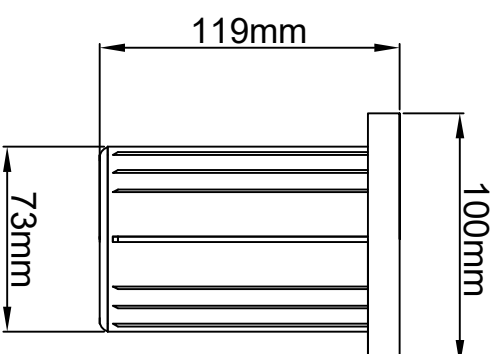
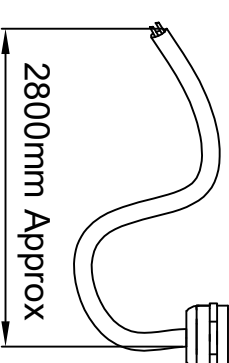
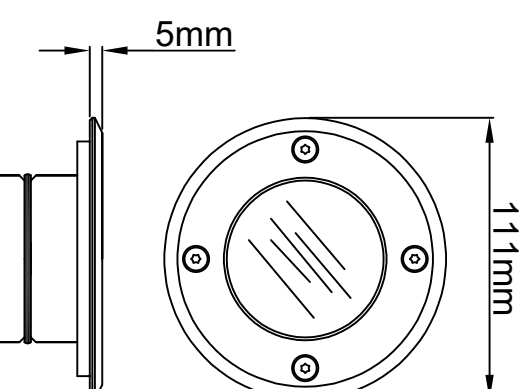
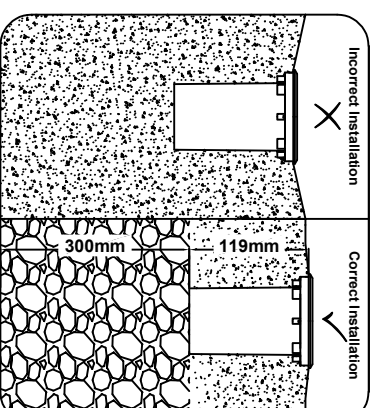

Fig. 1



Details	
LED 3 x 1W	
KSR9926 Warm White 3000K 168 Lumens	
KSR9927 Cool White 6000K 200 Lumens	
The light source of this luminaire is not replaceable; when the light source reaches its end of life the whole luminaire shall be replaced	

This product contains a light source of energy efficiency class G

KSR Lighting Aftersales: 023 92 674343

E-mail: [aftersales@ksrlighting.com](mailto:aftersales@ksrlighting.com)

