

Installation Sheet KSR7193

Moby Square LED Exterior LED Wall Light

Read these instructions before commencing installation. Please give these instructions to the owner/occupier after installation to retain for future reference/maintenance.

Available finish:- Anthracite Only

IP44 UK CA 0.5m 240V~50HZ 2x9W

These fittings are Class I and must be Earthed

Important Information

It is recommended that these luminaires are installed and fitted by a qualified electrician ensuring the installation complies with current IEE wiring regulations & local building control. These products are designed for connection to a 240V~50Hz supply.

Any faulty, broken or damaged luminaires should be replaced immediately.

KSR will not accept responsibility for any claims arising from a poor installation.

Please Note: The limited warranty shall be deemed null and void in the following circumstances:

Failure by the installer, end user or any third party to exercise caution to protect any covered product or part from outside damage, adverse temperature (normal operating ambient temperature -15°C - +40°C), humidity conditions, fluctuations in the electrical system or physical abuse as well as failure related to workmanship in the installation of the products or parts.

Important User Advice

Always switch off mains supply before servicing.

Do not use Megger or similar high voltage instruments. Due to the fact this luminaire contains electronic components that may be damaged by high test voltages, they must be disconnected from the circuit before testing. To prevent damage to the driver, do not mix with conventional magnetic ballasts on the same electrical circuit. At the end of life the luminaire is classed as WEEE under directive 2014/30/EU and should be disposed of in accordance with local legislation. General maintenance and cleaning should be performed at least quarterly.

Clean product outer using a damp cloth. After any maintenance, remember to check all seals are intact.

Installation Procedure

Familiarize yourself with the fixture, wind back the grub screw that secures the main fitting to the mounting plate.

Set grub screw back enough to allow the base plate to come away from the body.

Offer the base plate up to a suitable surface and mark atleast two fixing points, ensuring the cable entry is towards the bottom of the plate.

Once drilled, dress the mains supply cable through the grommet and secure to the wall. To make installation easier remove the rubber grommet from the housing.

Terminate the fixed wiring into the terminal block, following the guide below and/or the markings on the fitting.

Ensure the main gasket is seated correctly on the base plate and place the fitting onto it, over up the fitting to the base plate, tighten the grub screw ensuring the seal is compressed sufficiently.

Turn on the power and test the luminaire.

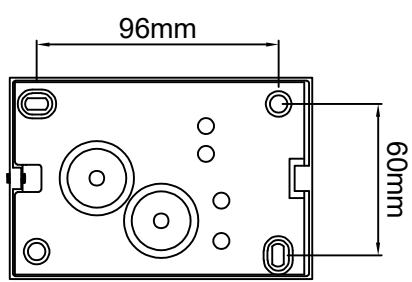
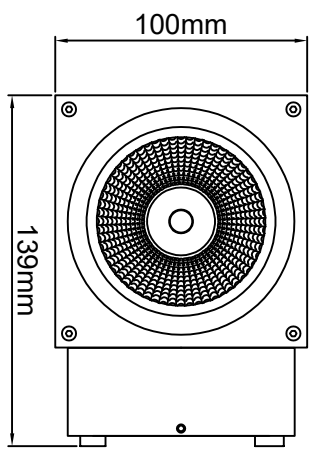
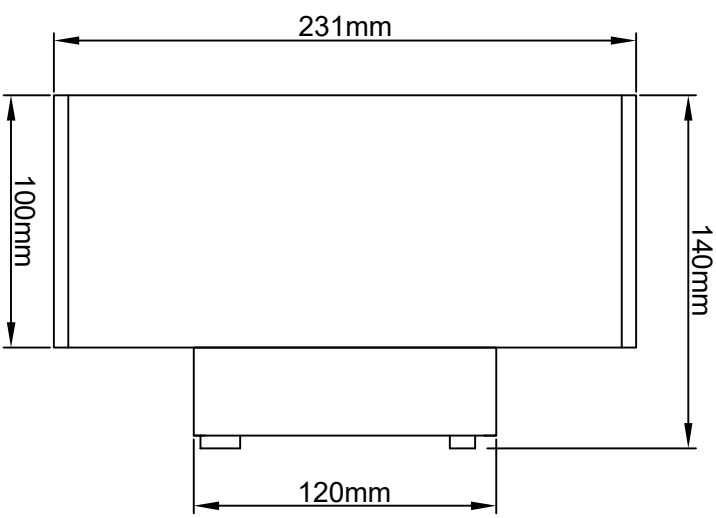

Mounting Plate

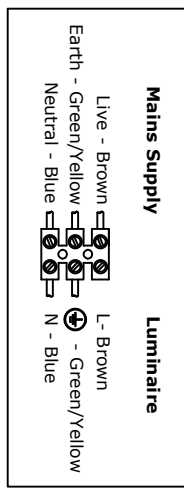

Lamp Details
2x9W LED Non Replaceable Module
3000k Warm White
CRI Ra:82
1700 Lumens (850lm per head)
The light source of this luminaire is not replaceable, when the light source reaches its end of life the light source and control gear shall be replaced



KSR Lighting Aftersales: 023 92 674343
E-mail: aftersales@ksrlighting.com