

# Sevas Range

*Exterior Wall Lighting*



Data Sheet

## Product Information

The Sevas wall light is perfect for lighting external walls using either the single or the double up & down version.

This Range is available in 3 finishes across 3 varieties which makes this range a comprehensive portfolio ideal for residential and commercial applications.

## Product Features

- 1 year warranty
- IP55
- Single or double GU10 35W max.
- Single/double version: 90° Tilt, 180° Rotation
- Suitable for retro fit GU10 LED lamps
- Products supplied less lamps

KSR7100



Silver

KSR7178



Rusty Brown

KSR7112



Anthracite

# Product Specification

Product Code	Product Description	Wattage	Lamp Cap	Energy Efficiency Class	Protection Class
KSR7100	Sevas GU10 Single Wall Light Silver Finish	50w	GU10	Lamp Dependant	I
KSR7101	Sevas GU10 Up/Down Wall Light Silver Finish	50w	2x GU10	Lamp Dependant	I
KSR7108	Sevas GU10 Single Wall Light Anthracite Finish	50w	GU10	Lamp Dependant	I
KSR7109	Sevas GU10 Up/Down Wall Light Anthracite Finish	50w	2x GU10	Lamp Dependant	I
KSR7112	Sevas GU10 Double Wall Light Anthracite Finish	50w	2x GU10	Lamp Dependant	I
KSR7177	Sevas GU10 Single Wall Light Rusty Brown Finish	50w	GU10	Lamp Dependant	I
KSR7178	Sevas GU10 Up/Down Wall Light Rusty Brown Finish	50w	2x GU10	Lamp Dependant	I

Nominal voltage	220~240VAC
Operating frequency	50-60Hz
Circuit Wattage	Max 50w Halogen
IP rating	55

## Construction

Body:	Cast Aluminium
Lens:	Clear Glass

## Standards

BSEN60598-1:2021      Luminaires – Part 1: General requirements and tests

## In Conformity with

LVD	Low voltage directive 2014/35/EU
RoHS	Restriction of hazardous substances 2015/863/EU

## Product Dimensions

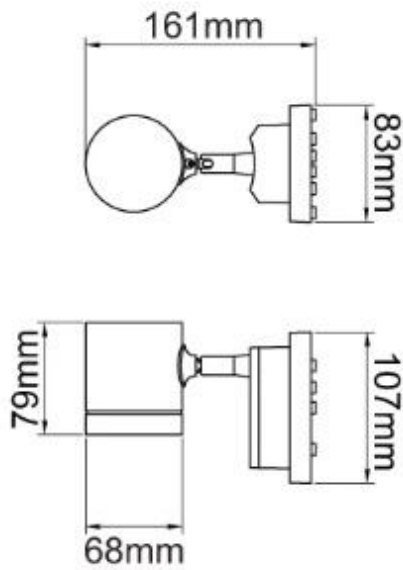

**KSR7100/7108/7177**

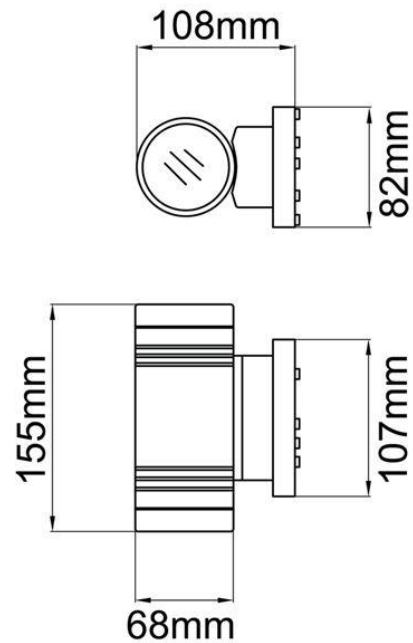

**KSR7101/7109/7178**

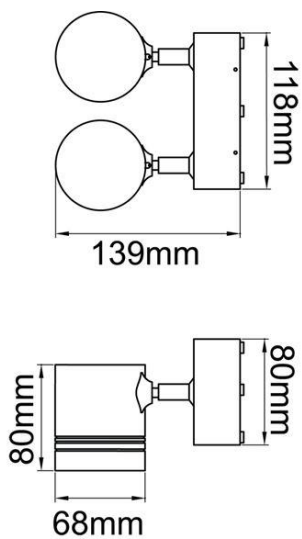

**KSR7112**

KSR Lighting is constantly developing and improving its products. For this reason, all product descriptions in this data sheet are intended as a general guide, and KSR may change specifications from time to time in the interest of product development, without prior notification or public announcement. All descriptions in this data sheet present only general particulars of the goods to which they refer and shall not form part of any contract. Data in this guide has been obtained in controlled experimental conditions. However, KSR Lighting cannot accept any liability arising from the reliance on such data to the extent permitted.