

# Installation Sheet KSR8403

Read these instructions before commencing installation. Please give these instructions to the owner/occupier after installation to retain for future reference/maintenance.

IP44   240VAC~50HZ

These Sensors are Class II and do not require an Earth connection

## Important Information

It is recommended that these Sensors are installed and fitted by a qualified electrician ensuring the installation complies with current IEE wiring regulations & local building control. These products are designed for connection to a 240V~50Hz supply.

Any faulty, broken or damaged luminaires should be replaced immediately.

KSR will not accept responsibility for any claims arising from a poor installation.

Please Note: The limited warranty shall be deemed null and void in the following circumstances: Failure by the installer, end user or any third party to exercise caution to protect any covered product or part from outside damage, adverse temperature (normal operating ambient temperature -20 ~ +40°C), humidity conditions, fluctuations in the electrical system or physical abuse as well as failure related to workmanship in the installation of the products or parts.

## Installation Guidelines

These sensors can be wired through two blank grommets (2x16mm).

Remove the sensor from the back box, use a small flat blade screwdriver to tease the two pieces apart as per Fig 1  
Dress the cables through the back box and secure to suitable surface.

Terminate your mains input cable into the L (Brown) & N (Blue) terminals, then connect the luminaire wires into the L' (Red) & shared N (Blue) terminals on the sensor.

On initial installation it is advised you leave the time setting to 10 Seconds and the Lux setting on the 'sun' symbol. This will allow you to test and set up the sensor as required.

**Time** - This sensor can switch the lighting from a minimum of 10 Seconds to a maximum of 15 minutes, carefully turn the time dial to the required time.

**Lux** - This sensor will activate between daylight and 3 Lux, in order to achieve the required 'on' time it is recommended that the sensor is set to 30 Lux and wait 24 hours, after this period you can adjust the Lux control to up or down accordingly.

**Position** - Ensure you position the sensor in a location suited to the the required activation point, this may not be central to any space. Avoid placing the sensor near heating vents or highly reflective surfaces as this may cause unwanted triggering.

## PIR Specification:

Mains Input - 220-240v AC

Lux Control - 3-2000 Lux Adjustable

Time Setting - Min 10 Seconds +/- 3 Seconds

Max 15 Minutes +/- 2 Minutes

Rated Load - LED, 400W/

Halogen, 800W

Detection Area - 180°

Detection Distance - 12m Max

Parasitic Power - 0.5W

Installation Height - 1.8 - 2.5m

Fig 1.

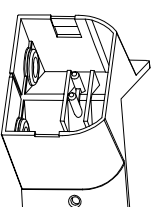
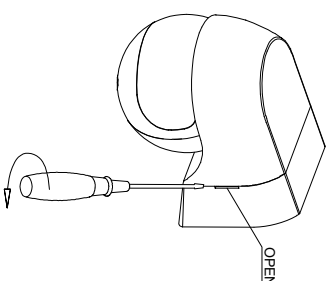

Optional Corner Bracket (supplied)

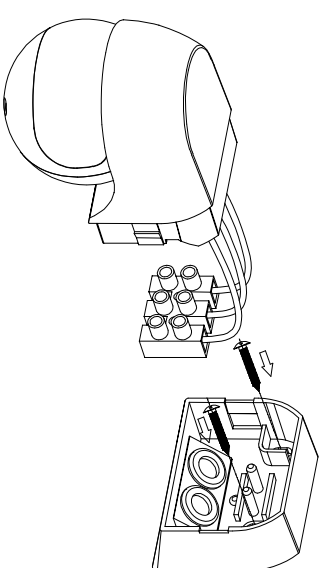

## KSR Controls



## Passive Infrared

Available finish:- White Finish

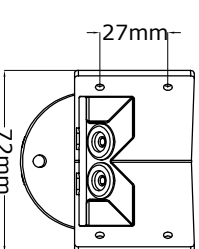
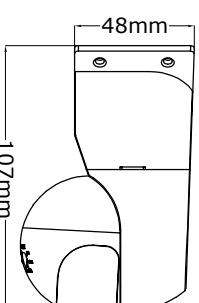
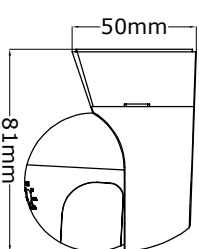
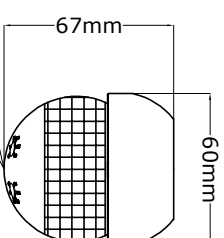
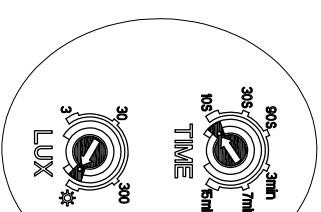

Shown Optional Corner Bracket



KSR Lighting Aftersales: 023 92 674343  
E-mail: [aftersales@ksrlighting.com](mailto:aftersales@ksrlighting.com)